



A Z O M

Start Guide

A Z O M BUDS 2

THANK YOU FOR CHOOSING A Z O M PRODUCT!

Usage tips

Please read this manual carefully before using.

If you charge buds when they are wet, has sweat on them, etc. the charging terminals will corrode. Please wipe off moisture with a dry and soft cloth, or let it dry naturally before recharging.



Don't leave the buds in your pockets when washing clothes such as pants, shirts, etc.

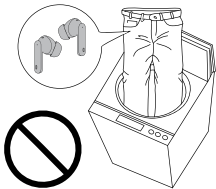

Tips

▲ If one bud does not work (buds don't have actively pairing function).

Solution:

Step 1: Turn off your mobile's Bluetooth.



Step 2: Put the two buds back into the charging case and close the lid.

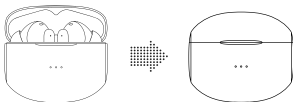

Step 3: Take out the two buds and place them on a table, wait for 15 s to pair automatically.

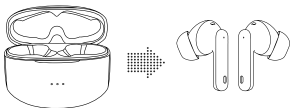

Product Details

Charging case

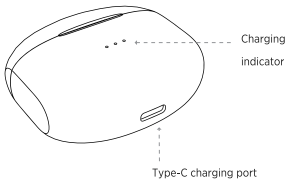

Touch area

Microphone

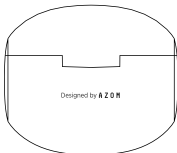
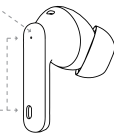

Product Usage

- ⚠ Use the original charging cable to charge. Don't use high voltage charging devices.

Charge the case firstly before using buds for first time.

Charging case indicator lights will flash when it is charging. The lights will stay on after fully charged.

Charging case indicator lights will stay on when it is charging the buds. The lights will be off after fully charged.

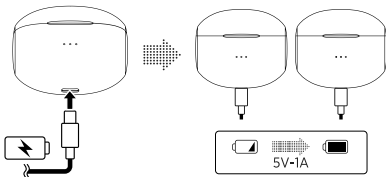

Bluetooth Pairing

Take out buds and search for "AZOM Buds 2" on your mobile to connect.

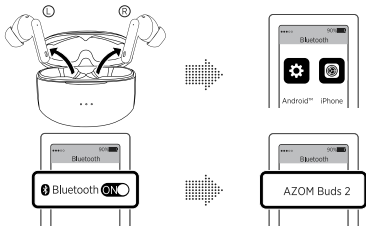





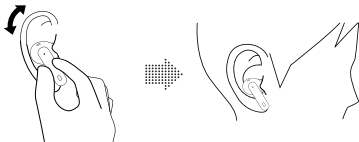



How to Wear

Take out buds and wear them on your ears, then wiggle them slightly for a better fit and comfort.





Buds Function

-  **Turn on:** Charging: Automatically turn on once lid open
Turn off: Press and hold for 3 seconds.
-  **Turn off:** Not connected: It will automatically turn off after 3 minutes.
Connected: Auto turn off when the battery is below 3.1V.
Long press for 5 seconds to turn off
Put buds in the charging case and close the lid.
-  **Play/Pause music:** Double click left or right bud.
-  **Previous song:** Press 2s on left bud.
-  **Next song:** Press 2s on right bud.
-  **Activate/close voice assistant:** Triple click right bud.
-  **Transparency mode:** Triple click left bud.
-  **ANC turn on:** Triple click left bud.
-  **ANC turn off:** Triple click left bud.

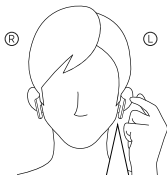
Call Function



	Answer the call	When calling	Double click left or right bud.
	Hang up	During a call	Double click left or right bud.
	Reject	When calling	Long press left or right bud for 2 seconds.

Buds Charging

Put the bud into the case to charge when its low power.

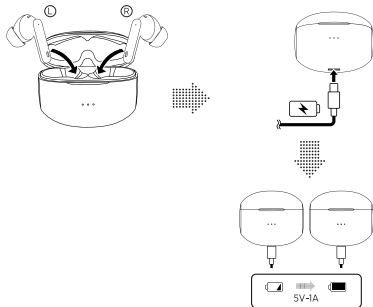

Product Specification

- Bluetooth Version: V5.2
- Talk time: - 4 hours
- Stand-by time: - 140 days
- Charging time: 1.5 hours
- Battery capacity: 40 mAh
- Charging voltage: DC 5V
- Transmission distance: 10m -15m
- Music playtime: 6-8 hours
- Frequency Response: 20-20000 Hz
- Charging case battery: 320 mAh

Safety Information

Before using and operating AZOM buds, please read and follow the below precautions to ensure the best performance of it and to avoid dangerous or illegal situations.

Hearing Loss: Listening to sound at high volume may permanently damage your hearing. When you use buds to listen to music or calls, it is recommended to use the minimum volume required for music or calls to avoid hurting your hearing.

- Exposure to high-level volume while driving, driving attention may be distracted and cause accidents.

Operating environment: Do not use the device in dusty, sharp, compact or near magnetic fields to avoid failure of the internal circuit of the device.

- When installing the device, please keep away from strong magnetic fields or electrical appliances with strong magnetic fields, such as ovens and refrigerators.

- Do not use the device in thunderstorm weather, Thunderstorm weather may cause equipment failure or electric shock hazard.

- Please use the device within a

temperature range of -10°C - $+55^{\circ}\text{C}$, and store the device and its accessories within a temperature range of -40°C - $+70^{\circ}\text{C}$. When the ambient temperature is too high or too low, it may cause device function failure. When the temperature is below 5°C , the performance of the battery is limited.

- Do not place the device in direct sunlight, such as the dashboard or window sill of a car.

- Do not place the device near heating sources or exposed fire sources, such as electric heaters, ovens, water heaters, stoves, candles, or other places that may generate high temperatures.

- Do not place sharp metal objects such as pins near the device's earpiece or speaker, otherwise the metal objects may adhere and cause injury to you.

Child health

- This device and its accessories may contain some small parts. Keep the device and its accessories in a place out of children's reach. Children may inadvertently damage the device and its accessories, or swallow small parts, causing suffocation or other hazards.

This device is not a toy; children should only use this device under adult supervision.

Battery safety

- Do not disassemble or modify the battery, or immerse in water or other liquids, to avoid battery leakage, excessive, fire or explosion.
- Do not drop, crush or puncture the battery. It can cause internal short circuits and overheating.
- This device is equipped with a non-removable built-in battery.
- Do not replace the battery yourself to avoid damage to the battery or device. The battery can only be replaced by AZOM Customer Service Center.

Charger safety

- When charging the device, the power socket should be installed near the device and should be easily accessible.
- When charging is completed or not charging, disconnect the charger from the device and unplug the charger from the power outlet

Precautions

1. The buds should be stored in a dry/ventilated environment and avoid contacting with oil, water vapor, steam, moisture and dust to prevent the performance of the product.
2. Avoid using harsh organic solvents or items containing these ingredients to clean the buds.
3. The buds should be used correctly according to the requirements, and pay attention to the effect of the environment on the product. Make sure the connection is smooth and recommend a distance between them within 10 meters.
4. If the buds failed to connect or with poorly connection, please do not dismantle them or the accessories privately. Otherwise no warranty.
5. When charging the buds, please use the standard car charger or the charger specified by our company.
6. To ensure the normal use of the buds, please make sure they are fully charged.

A Z O M

